



ADDENDUM 1

PROJECT NAME: Churchill Ave Area Drainage Improvements

DATE: 11/01/2023

PROJECT NO: 23-03797

This addendum is separated into sections for convenience; however, all respondents, bidders, contractors, subcontractors, material men, and other parties must be responsible for reading the entire addendum. The failure to list an item or items in all affected sections of this addendum does not relieve any party affected from performing as per instructions, providing that the information is set forth one time any place in this addendum. These documents will be attached to and will become part of the Contract Documents for this project. The respondent/bidder is required to acknowledge the receipt of this addendum.

GENERAL:

1. The following changes and/or additions to the Contract Documents, via this addendum, must apply to proposals made for and to the execution of the various parts of the work affected thereby.
2. Careful note of the Addendum must be taken by all interested parties and all trades affected must be fully advised in their performance of the work involved.
3. This Addendum is hereby made part of the project requirements and contract documents for the above reference project. Ensure to acknowledge this Addendum in CivCast when downloading this Addendum. Acknowledgement of this Addendum is a requirement in order to submit bid in CivCast. This addendum consists of the items and their associated attachments as listed below:

A. ADMINISTRATIVE CHANGES TO BID DOCUMENTS:

1. Change of Bid Opening date.
 - a. Current Bid Opening date: November 7, 2023 @ 2:00 pm.
 - b. New Bid Opening date: November 10, 2023 @ 2:00 pm.

B. CHANGES TO PLANS / SPECIFICATIONS:

1. Revised Plan Sheet 79 – Cross Sections – Revised grading and riprap tie in elevations callouts to match details.
2. Revised Plan Sheet 96 – Cross Sections – Revised grading and riprap tie in elevations callouts to match details.
3. Revised Plan Sheet 97 – Cross Sections – Revised grading and riprap tie in elevations callouts to match details.
4. Revised Plan Sheet 98 – Cross Sections – Revised grading and riprap tie in elevations callouts to match details.
5. Revised Plan Sheet 112 – Drainage Details – Updated riprap elevation.

C. QUESTIONS & RESPONSES:

1. Question: Would you please post the pre-bid meeting attendees list?

Response: The attendees list has been uploaded.

2. Question: Cross section @ station 18+22.38, grading elevation at right side does not match at end of grading limits. Please clarify.

Response: Cross section plan sheet 79 has been updated to reflect the correct tie in elevations to match the riprap details and grading layouts.

3. Question: Cross sections @ station 21+80.00 to 22.21.98 grading elevation at left side does not match at end of ROW. Please clarify.

Response: Cross section plan sheets 96-98 have been updated to reflect the correct tie in elevations to match the riprap details and grading layouts.

4. Question: SAWS plan sheet 4 of 8 lacks call out for Relay ¾” short service customer shut-off valve. Please clarify.

Response: Service Relay for the ¾” Service on Minnie Street plan sheet 4 of 8 per the standard SAWS legend is indicated by a solid thick line that can be found at approximate STA 11+65 near the water relocation south side tie-in just north of the proposed 6” Gate Valve. The Service Relay is also identified at the property line adjacent to the relocate meter triangle symbol with a callout signifying a ¾” Service for SAWS Tap #274697. Regarding Customer Shut off Valve, see Plan Note #2 of SAWS Sheet 4 of 8 indicating Contractor shall add or replace customer shut off valves for every service.

5. Question: Please clarify location of existing meter new meter box relocation.

Response: 833 Existing Meter and New Meter Box Relocation item is located on Minnie Street plan sheet 4 of 8. Per the standard SAWS legend, relocate meter is indicated on the drawing by a triangle. The existing meter symbol and the proposed new meter box relocation triangle can be found at approximate STA 11+65 near the property line at the end of the service relay.

6. Question: Please verify proposed fence quantity on plan sheet 49/135.

Response: Fence quantity has been verified and is showing the correct pay length. Plans are showing the proposed fence parallel to the channel as well as there is 100 LF of fence running parallel to Chloe that is called out to be installed.

SIGNED AND SEALED BY CONSULTANT (Engineer/Architect of Record)

By signing and sealing this addendum, the Engineer/Architect of Record acknowledges that the sign/seal is only for changes/clarifications to the items associated with the Engineer’s/Architect’s work referenced in this addendum.



11/01/23



END OF ADDENDUM NO. 1

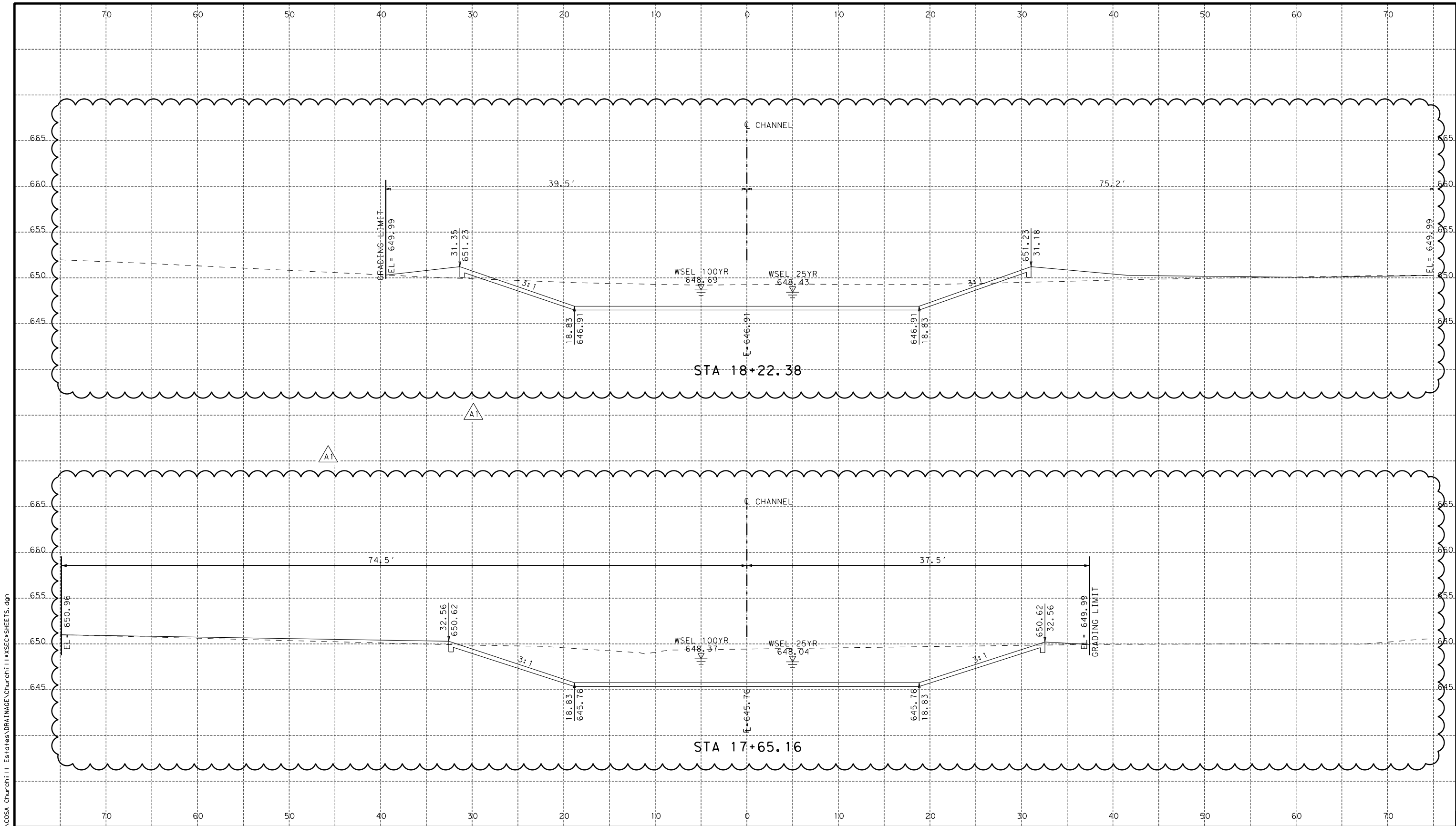

K:\COSA Church II Estates\DRAWING\Church II\XSEC-SHEETS.dgn

10/31/2023

NOTES:

1. HORIZONTAL LOCATION OF EXISTING UTILITIES SHOWN ARE BASED ON RECORD DRAWINGS AND ARE APPROXIMATE. DEPTHS OF UTILITIES SHOWN ARE ASSUMED.
2. ACTUAL LOCATIONS AND DEPTHS WILL BE FIELD VERIFIED BY THE CONTRACTOR PRIOR TO ANY CONSTRUCTION.
3. THE CONTRACTOR WILL BE RESPONSIBLE FOR THE PROTECTION OF ALL UTILITIES DURING CONSTRUCTION.



REVISIONS		
DATE	NO.	DESCRIPTION
OCT '23	A1	REVISED TIE-IN ELEVATIONS

CAMACHO-HERNANDEZ & ASSOCIATES, LLC
 415 EMBASSY OAKS - SUITE 205 SAN ANTONIO, TX. 78216
 OFFICE: (210) 341-6200 FAX: (210) 341-6300
 FIRM NUMBER: F-8478

CITY OF SAN ANTONIO
 PUBLIC WORKS DEPARTMENT

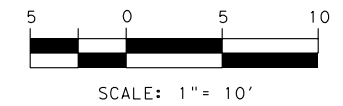

CHURCHILL AVE AREA DRAINAGE IMPROVEMENTS

CROSS SECTIONS

CHANNEL

SHEET 29 OF 56

100 % SUBMITTAL	PROJECT NO.: 23-03797	DATE: 10/31/2023
DRWN. BY: PG	DSGN. BY: JAS	CHKD. BY: AC

K:\COSA Church II Estates\DRAWING\Church II\XSEC-SHEETS.dgn

10/31/2023

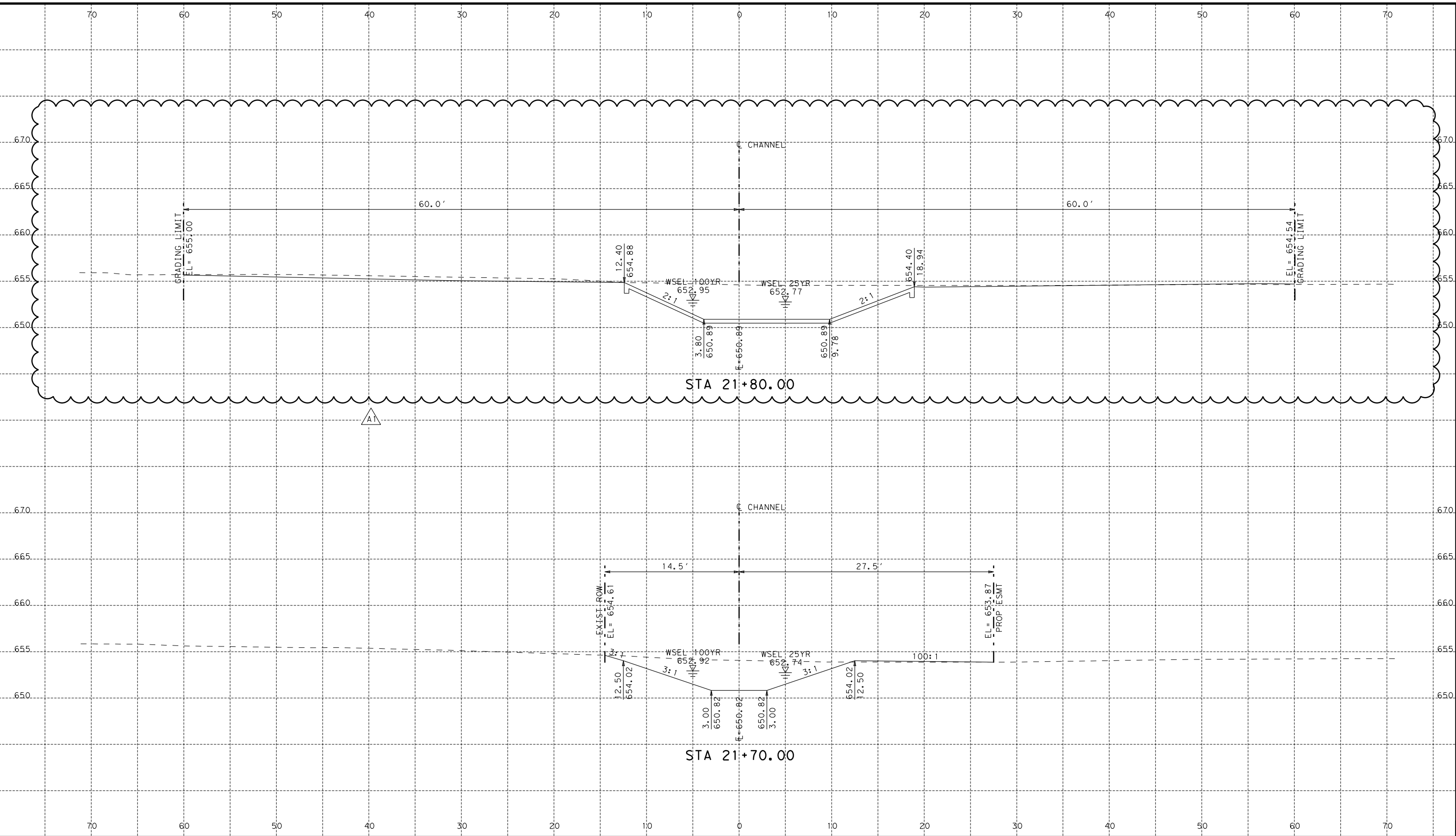

NOTES:

- HORIZONTAL LOCATION OF EXISTING UTILITIES SHOWN ARE BASED ON RECORD DRAWINGS AND ARE APPROXIMATE. DEPTHS OF UTILITIES SHOWN ARE ASSUMED.
- ACTUAL LOCATIONS AND DEPTHS WILL BE FIELD VERIFIED BY THE CONTRACTOR PRIOR TO ANY CONSTRUCTION.
- THE CONTRACTOR WILL BE RESPONSIBLE FOR THE PROTECTION OF ALL UTILITIES DURING CONSTRUCTION.



REVISIONS		
DATE	NO.	DESCRIPTION
OCT '23	A1	REVISED TIE-IN ELEVATIONS

CAMACHO-HERNANDEZ & ASSOCIATES, LLC
 415 EMBASSY OAKS - SUITE 205 SAN ANTONIO, TX. 78216
 OFFICE: (210) 341-6200 FAX: (210) 341-6300
 FIRM NUMBER: F-8478

CITY OF SAN ANTONIO
 PUBLIC WORKS DEPARTMENT

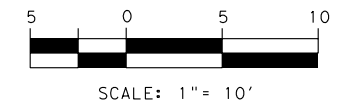

CHURCHILL AVE AREA DRAINAGE IMPROVEMENTS

CROSS SECTIONS

CHANNEL

SHEET 46 OF 56

100 % SUBMITTAL	PROJECT NO.: 23-03797	DATE: 10/31/2023
DRWN. BY: PG	DSGN. BY: JAS	CHKD. BY: AC

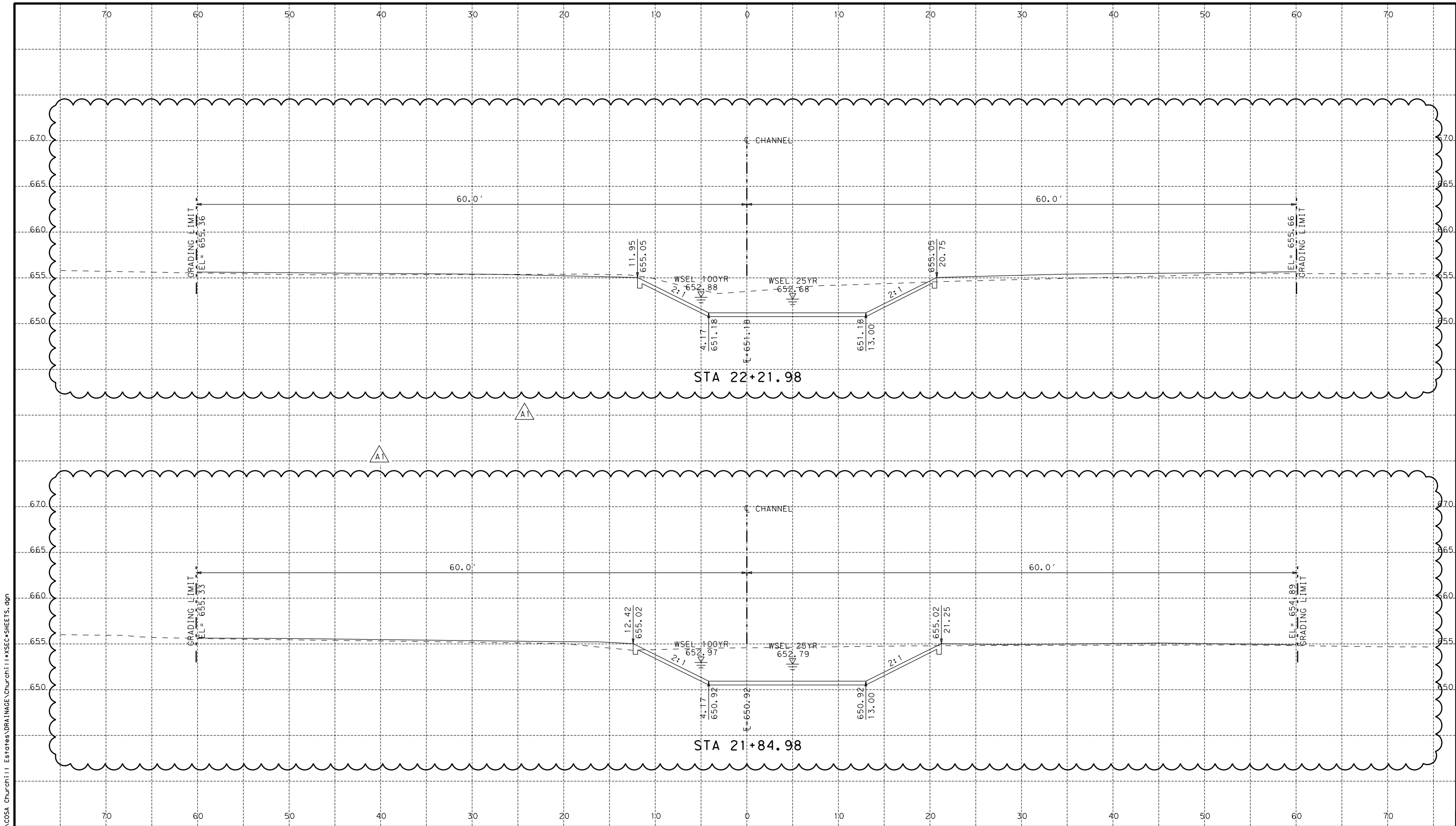

K:\COSA Church\11 Estates\DRAINAGE\Church\11\XSEC-SHEETS.dgn

10/31/2023

NOTES:

1. HORIZONTAL LOCATION OF EXISTING UTILITIES SHOWN ARE BASED ON RECORD DRAWINGS AND ARE APPROXIMATE. DEPTHS OF UTILITIES SHOWN ARE ASSUMED.
2. ACTUAL LOCATIONS AND DEPTHS WILL BE FIELD VERIFIED BY THE CONTRACTOR PRIOR TO ANY CONSTRUCTION.
3. THE CONTRACTOR WILL BE RESPONSIBLE FOR THE PROTECTION OF ALL UTILITIES DURING CONSTRUCTION.



REVISIONS		
DATE	NO.	DESCRIPTION
OCT '23	A1	REVISED TIE-IN ELEVATIONS

CAMACHO-HERNANDEZ & ASSOCIATES, LLC
 415 EMBASSY OAKS - SUITE 205 SAN ANTONIO, TX. 78216
 OFFICE: (210) 341-6200 FAX: (210) 341-6300
 FIRM NUMBER: F-8478

CITY OF SAN ANTONIO
 PUBLIC WORKS DEPARTMENT

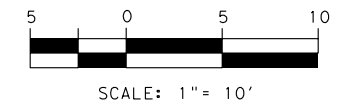

CHURCHILL AVE AREA DRAINAGE IMPROVEMENTS

CROSS SECTIONS

CHANNEL

SHEET 47 OF 56

100 % SUBMITTAL	PROJECT NO.: 23-03797	DATE: 10/31/2023
DRWN. BY: PG	DSGN. BY: JAS	CHKD. BY: AC

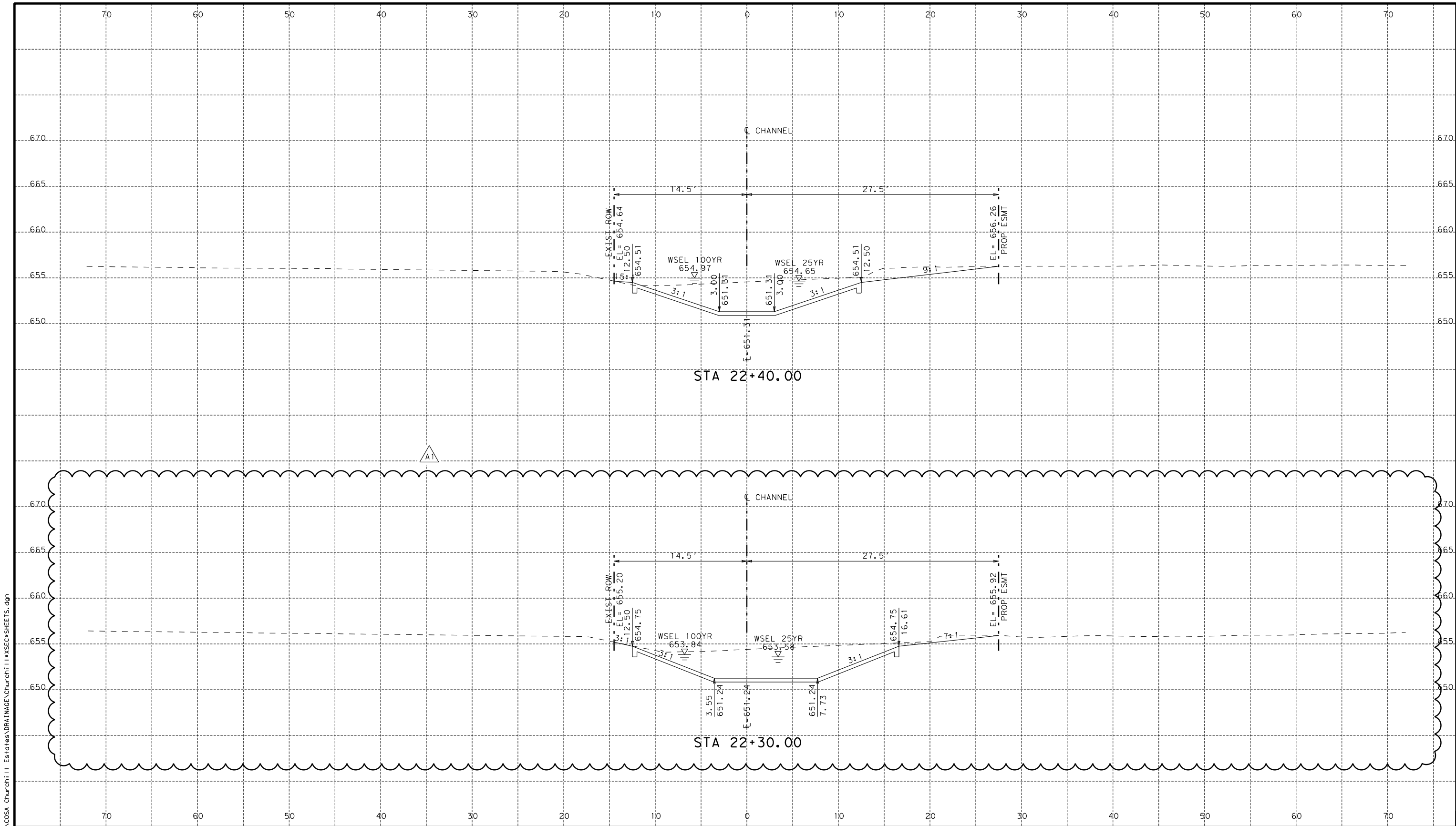

K:\COSA Church\11 Estates\DRAINAGE\Church\11\XSEC-SHEETS.dgn

10/31/2023

NOTES:

1. HORIZONTAL LOCATION OF EXISTING UTILITIES SHOWN ARE BASED ON RECORD DRAWINGS AND ARE APPROXIMATE. DEPTHS OF UTILITIES SHOWN ARE ASSUMED.
2. ACTUAL LOCATIONS AND DEPTHS WILL BE FIELD VERIFIED BY THE CONTRACTOR PRIOR TO ANY CONSTRUCTION.
3. THE CONTRACTOR WILL BE RESPONSIBLE FOR THE PROTECTION OF ALL UTILITIES DURING CONSTRUCTION.



REVISIONS		
DATE	NO.	DESCRIPTION
OCT '23	A1	REVISED TIE-IN ELEVATIONS

CAMACHO-HERNANDEZ & ASSOCIATES, LLC
 415 EMBASSY OAKS - SUITE 205 SAN ANTONIO, TX. 78216
 OFFICE: (210) 341-6200 FAX: (210) 341-6300
 FIRM NUMBER: F-8478

CITY OF SAN ANTONIO
 PUBLIC WORKS DEPARTMENT

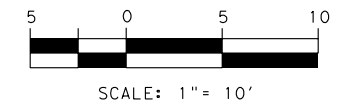

CHURCHILL AVE AREA DRAINAGE IMPROVEMENTS

CROSS SECTIONS

CHANNEL

SHEET 48 OF 56

100 % SUBMITTAL	PROJECT NO.: 23-03797	DATE: 10/31/2023
DRWN. BY: PG	DSGN. BY: JAS	CHKD. BY: AC

SHEET NO.: 98 OF 135

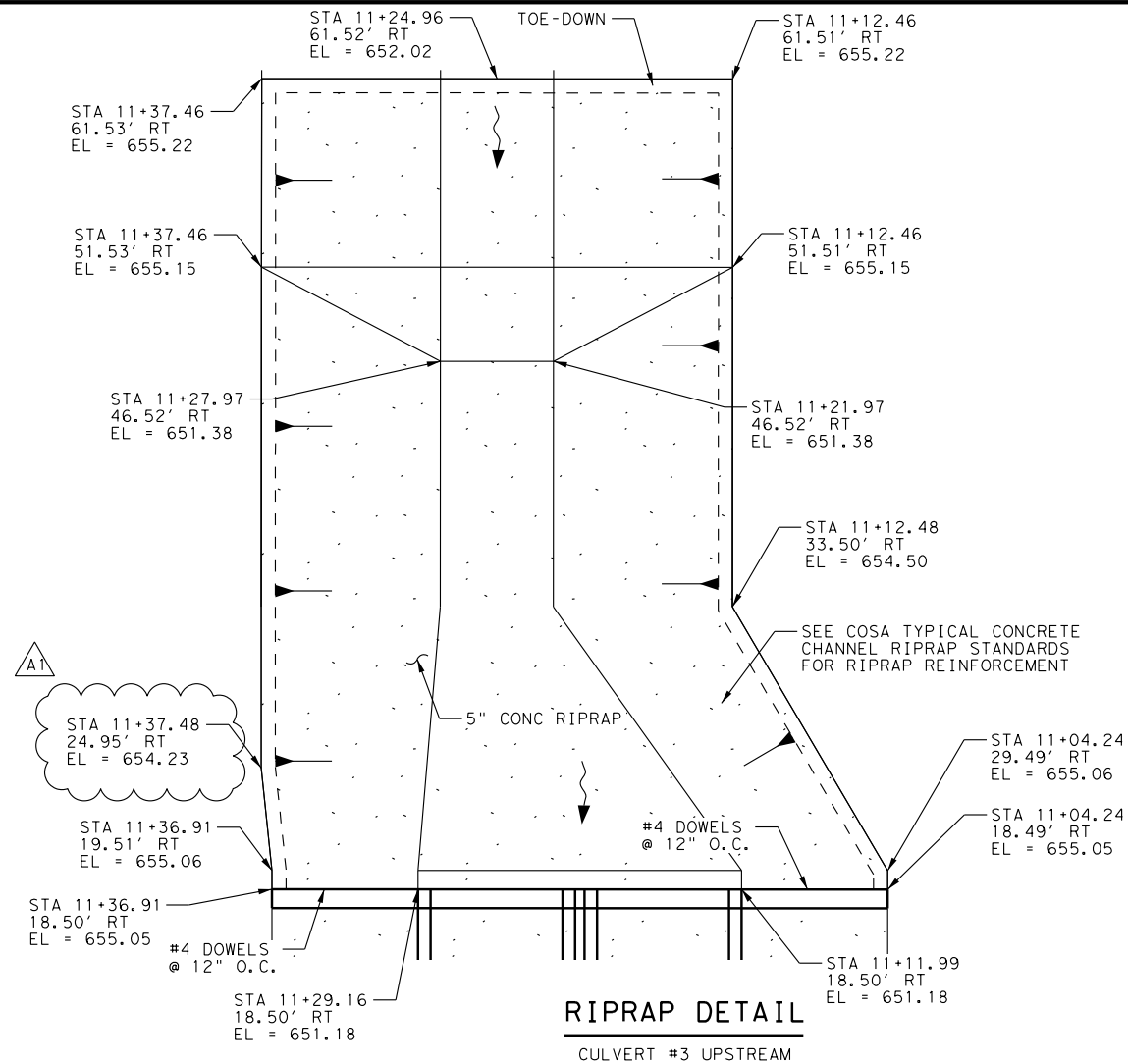

RIPRAP DETAIL
CULVERT #3 UPSTREAM

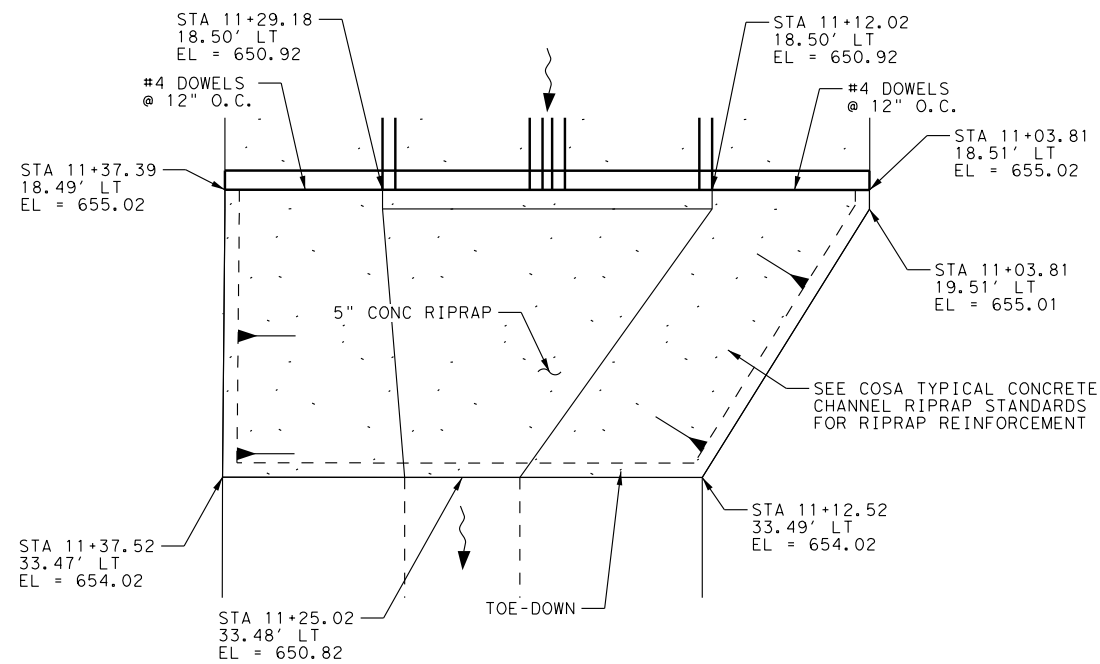

RIPRAP DETAIL
CULVERT #3 DOWNSTREAM

NOTES:

1. REFER TO SHEET 115 "TYPICAL CONCRETE CHANNEL RIP-RAP" FOR ALL ADDITIONAL DETAILS. (I.E. REINFORCEMENT, TOE-DOWN, ETC.)

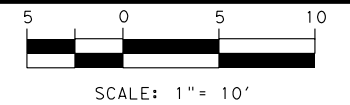

REVISIONS		
DATE	NO.	DESCRIPTION
OCT '23	A1	REVISED RIPRAP ELEVATION



CAMACHO-HERNANDEZ & ASSOCIATES, LLC
415 EMBASSY OAKS - SUITE 205 SAN ANTONIO, TX. 78216
OFFICE: (210) 341-6200 FAX: (210) 341-6300
FIRM NUMBER: F-8478

CITY OF SAN ANTONIO
PUBLIC WORKS DEPARTMENT
CHURCHILL AVE AREA DRAINAGE IMPROVEMENTS

DRAINAGE DETAILS
CULVERT #3 @ CHLOE

SHEET 3 OF 4

100 % SUBMITTAL	PROJECT NO.: 23-03797	DATE: 10/31/2023
DRWN. BY: ES	DSGN. BY: MR	CHKD. BY: JH

SHEET NO.: 112 OF 135