

**CITY OF SAN ANTONIO
INTERDEPARTMENTAL MEMORANDUM
PUBLIC WORKS DEPARTMENT**

CONSENT AGENDA
ITEM NO. 13

TO: Mayor and City Council

FROM: Thomas G. Wendorf, P.E., Director of Public Works

THROUGH: Terry M. Brechtel, City Manager

COPIES: Melissa Byrne Vossmer; Andrew Martin; Louis A. Lendman; Milo D. Nitschke; and file

SUBJECT: Clark Avenue from Fair to Southcross

DATE: January 29, 2004

SUMMARY AND RECOMMENDATIONS

This ordinance amends a professional service contract in the amount of \$270,011.64 payable to Civil Engineering Consultants, Inc. (CEC), a non-MBE firm, for professional engineering services, and authorizes \$27,201.00 for additional design contingency for a total amount of \$297,212.64 in connection with the Clark Avenue from Fair to Southcross Project, an authorized 1999 General Obligation Street Improvement Bond and Metropolitan Planning Organization (MPO) project located in Council District 3.

Staff recommends approval of this ordinance.

BACKGROUND INFORMATION

This ordinance will amend the professional services agreement as part of the anticipated design implementation for this project and provide additional compensation to Civil Engineering Consultants, Inc. (CEC) for professional engineering services for the preliminary, intermediate and final design phases. The project is currently funded only through the schematic design phase.

Improvements to Clark Avenue from Fair to Southcross will consist of the reconstruction of the existing 2 lane roadway to 2 lanes with a center turn lane and will include curbs, 6-foot sidewalks at the curb in commercial sections, driveway approaches and underground storm drain system. The project construction is anticipated to begin in November of 2005 and be completed in February of 2007.

This professional service contract was originally approved by City Ordinance No. 92571 on September 28, 2000 and initially authorized \$60,235.00 for services related to this project. Subsequent Council action increased this contract amount to \$74,985.00. This ordinance will increase the total authorized for this professional service contract to \$344,996.64.

POLICY ANALYSIS

Approval of this ordinance will be a continuation of City Council policy to complete previously approved 1999 General Obligation Street Improvement Bond and MPO funded projects.

FISCAL IMPACT

This is a one-time capital improvement expenditure within budget and included in the FY 04-09 Capital Improvement Program Budget. Funds in the amount of \$297,212.64 are available from 1999 General Obligation Street Improvement Bonds and are authorized payable as follows:

\$270,011.64 Payable to Civil Engineering Consultants, Inc. for engineering expenses
\$ 27,201.00 Payable for design contingency

COORDINATION

This request for ordinance has been coordinated with the Office of Management and Budget and the Finance Department.

SUPPLEMENTARY COMMENTS

The Discretionary Contracts Disclosure Form required by the Ethics Ordinance is attached.

ATTACHMENTS

1. Project Map
2. Proposal
3. Discretionary Contracts Disclosure Form

for Maurela Shannon, P.E.
Thomas G. Wendorf, P.E.
Director of Public Works

Approved:

Melissa Byrne Vossmer
Melissa Byrne Vossmer
Assistant City Manager

f Terry M. Brechtel
Terry M. Brechtel
City Manager

CLARK - FAIR TO SOUTHCROSS

FAIR AVE.

CLARK

SOUTHCROSS

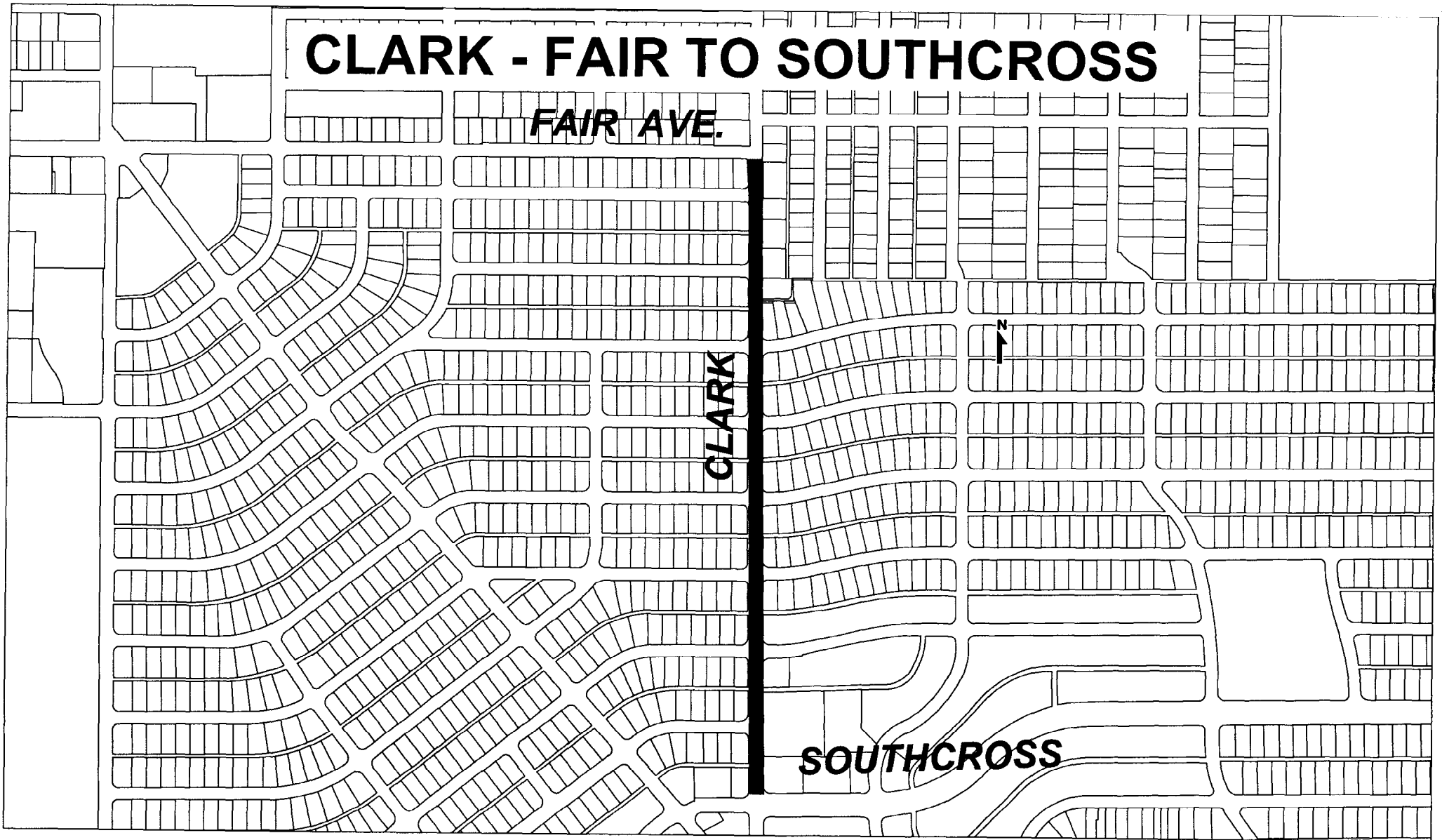



CIVIL ENGINEERING CONSULTANTS
DON DURDEN, INC.
MUNICIPAL • DEVELOPMENT
SURVEYING • TRANSPORTATION

December 31st, 2003

Samuel Hutchins IV, P. E.
City of San Antonio, Public Works Department
Capital Programs Division
P.O. Box 839966
San Antonio, TX 78283-3966

Reference: **Clark Avenue; Fair Avenue to Southcross**
CSJ: 0915-12-354

Subject: PS & E Fee

Mr. Hutchins:

CEC is submitting the proposed fee for the Project Specifications and Estimate (PS&E) portion of the project. The fee has a total of \$256,882.22. The breakdown of the fee is as listed below:

Basic Services

Preliminary Design	\$ 36,697.46
Intermediate Design	\$110,092.38
Final Design	\$ 91,743.65
TxDOT PS&E	\$ 18,348.73

Total = \$256,882.22

Additional Services

Geotech Support	\$ 13,129.42
-----------------	--------------

Total Engineering Fee \$ 270,011.64

If you have any questions please contact Garland Galm, P.E. or me at our offices.

Sincerely,

David M. Pulido, P.E.
Project Manager

Cc: Dennis Goodall, TxDOT CCMO
Attach: A/S

**CIVIL ENGINEERING CONSULTANTS
CLARK AVENUE, FAIR TO SOUTHCROSS**

Engineering Fee Proposal

TASK AND DESCRIPTION	SHEETS	PRINCP	PROJ MGR	PROJ ENGR	EIT	ENGR TECH	CADD OPER.	SURVEY CREW(3)	RPLS	SIT	CLERICAL	HOURS	COST
HOURLY RATE		\$150.00	\$135.00	\$90.00	\$75.00	\$75.00	\$58.00	\$120.00	\$110.00	\$70.00	\$40.00		
PRELIMINARY PHASE DESIGN													
I. BASIC SERVICES													
1. Site visits			2	4	4							10	\$ 930
2. Quality Control													\$ -
SUBTOTAL	0	0	2	4	4	0	0	0	0	0	0	10	\$ 930
I. ROADWAY DESIGN													
1. Develop Typical Sections sheets	2			2	4		8					14	\$ 944
2. Prepare initial roadway plan/profile sheets including												0	
Clark	8			4	24		48					76	\$ 4,944
Lyric	2			4	12		16					32	\$ 2,188
Intersecting Streets	10			8	20		40					68	\$ 4,540
3. Prepare initial Retaining Wall Layout sheets including												0	
Clark(east side)	8		1	8	24		32					65	\$ 4,511
Clark(west side)	6		1	8	24		32					65	\$ 4,511
Intersecting Streets	12		1	8	24		32					57	\$ 4,047
4. Prepare initial roadway design cross sections, including			2	8	12		32					54	\$ 3,746
intersecting streets (300 sections)												0	
5. Identify encroachments and request design exceptions			2	4	4	2	4					16	\$ 1,312
6. Assemble and plot Preliminary Plans			2		4		8				4	18	\$ 1,194
7. Coordinate Pavement Design			1									1	\$ 135
8. Coordinate with CoSA		1	2	2	8							13	\$ 1,200
SUBTOTAL	48	1	12	56	160	2	244	0	0	0	4	479	\$ 33,272
II. DRAINAGE													
1. Coordinate with Drainage Subconsultant			2	4	8						2	16	\$ 1,310
2. Review of Subconsultant plans			2		2	4						8	\$ 720
3. Coordinate with CoSA		1	4	4	4						1	14	\$ 1,390
SUBTOTAL	0	1	8	8	14	4	0	0	0	0	3	38	\$ 3,420
III. UTILITY MAPPING & COORDINATION													
1. Obtain existing utility records and maps												0	\$ -
2. Request utility companies to uncover inaccessible surface features (via CoSA)			1	1	0							2	\$ 225
3. Request underground utility locates from utility companies			2		2							4	\$ 420
4. Compile existing utility data collected in field into electronic mapping files				1	4		4					9	\$ 622
5. Determine location of existing utilities					2		4					6	\$ 382
6. Conduct field visits to verify utility locations				4	4							8	\$ 560
7. Request additional information from utility companies and resolve discrepancies				1	2							3	\$ 240
8. Submit utility layouts to utility companies for review and verification				2	2		4					8	\$ 562
9. Edit utility layouts per utility company comments				1	2		2					5	\$ 356
10. Coordinate with utility companies on relocations			1	1	1							3	\$ 300
SUBTOTAL	0	0	4	11	19	0	14	0	0	0	0	48	\$ 3,767
VI. MISCELLANEOUS ROADWAY													
1. Prepare Title Sheet and Index	2		0		2		2					4	\$ 266
2. Prepare Project Layout (BM & Alignment Data)	2		1	4	4		12					21	\$ 1,491
3. Formulate initial traffic control plans, detours, and sequence of work	16		4	12	24		16					56	\$ 4,348
4. Calculate major bid item quantities and prepare initial Grading Summary Sheet	2		1	2	2	8						13	\$ 1,065
5. Prepare preliminary opinion of probable construction cost using TxDOT Estimator Software				2	4	24						30	\$ 2,280
6. Prepare initial construction time estimate (CPM schedule) with Microsoft Project			1	4	12							17	\$ 1,395
7. Attend review meeting			4	4	4							12	\$ 1,200
8. Address review comments			4	8	12		40					64	\$ 4,480
SUBTOTAL	22	0	15	36	64	32	70	0	0	0	0	217	\$ 16,525
SUBTOTAL PRELIMINARY PHASE	70	2	37	104	242	36	314	0	0	0	7	744	\$ 57,914

**CIVIL ENGINEERING CONSULTANTS
CLARK AVENUE, FAIR TO SOUTHCROSS**

Engineering Fee Proposal

TASK AND DESCRIPTION	SHEETS	PRINCP	PROJ MGR	PROJ ENGR	EIT	ENGR TECH	CADD OPER.	SURVEY CREW(3)	RPLS	SIT	CLERICAL	HOURS	COST
HOURLY RATE		\$150.00	\$155.00	\$90.00	\$75.00	\$75.00	\$58.00	\$120.00	\$110.00	\$70.00	\$40.00		
INTERMEDIATE DESIGN PHASE													
I. BASIC SERVICES													
1. Site visits				4	4							8	\$ 660
2. Quality Control													\$ -
SUBTOTAL	0	0	0	4	4	0	0	0	0	0	0	8	\$ 660
II. ROADWAY DESIGN													
1. Refine Horizontal & Vertical Alignments			2	8	12		4					26	\$ 2,122
2. Refine & Submit Typical Sections			0	1	2		2					5	\$ 356
3. Refine roadway plan/profile sheets												0	\$ -
Clark			1	8	16		24					49	\$ 3,447
Intersecting Streets			1	8	16		24					49	\$ 3,447
4. Develop Retaining Wall Layout sheets including												0	\$ -
Clark (east side) - 7 sheets & Clark (west side) - 2 sheets			0	12	32		24					68	\$ 4,872
Intersecting Streets			0	8	18		18					44	\$ 3,114
5. Develop roadway design cross sections, including			0	8	24		32					64	\$ 4,376
Intersecting streets (300 sections)												0	\$ -
6. Prepare Intersection Grading Plans & address pedestrian issues			0	12	12	4	24					52	\$ 3,672
7. Assemble and plot plans			0	1	4		4					9	\$ 622
8. Coordinate with Subconsultants			2	4	8						4	18	\$ 1,390
9. Coordinate with CoSA		2	2	4	4						4	16	\$ 1,390
SUBTOTAL	0	2	8	74	148	4	156	0	0	0	8	37	\$ 28,808
III. UTILITY MAPPING & COORDINATION													
1. Obtain existing utility records and maps				1	1							2	\$ 165
2. Request utility companies to uncover inaccessible surface features (via CoSA)			1		1							2	\$ 210
3. Request underground utility locates from utility companies			1		1							2	\$ 210
4. Compile existing utility data collected in field into electronic mapping files				2	2		4					8	\$ 562
5. Determine location of existing utilities					2		2					4	\$ 266
6. Conduct field visits to verify utility locations				2	2							4	\$ 330
7. Request additional information from utility companies and resolve discrepancies				1	1							2	\$ 165
8. Submit utility layouts to utility companies for review and verification				1	1		2					4	\$ 281
9. Edit utility layouts per utility company comments				1	2		4					7	\$ 472
10. Coordinate with utility companies on relocations				1	1							2	\$ 165
SUBTOTAL	0	0	2	9	14	0	12	0	0	0	0	37	\$ 2,826
IV. DRAINAGE													
1. Assemble Intermediate Drainage Plans			1	4	4							5	\$ 435
2. Coordinate with Drainage Subconsultants			1	4	4		4				2	15	\$ 1,175
3. Review of Subconsultant plans				2			4					6	\$ 450
4. Coordinate with CoSA		1	2								4	7	\$ 580
5. Prepare Initial Storm Water Pollution Prevention Plans	4		2	4	8		24					38	\$ 2,622
SUBTOTAL	4	1	6	10	16	8	24	0	0	0	6	71	\$ 5,292
V. SIGNING, PAVEMENT MARKINGS AND SIGNALIZATION													
1. Prepare Signing and Pavement Marking Layouts including pay item quantities	8		0	2	12	24	16					54	\$ 3,808
2. Prepare Traffic Signal layouts w/ quantities for Southcross	1		2	4	8		8					22	\$ 1,694
3. Prepare phase sequence diagrams	1		1	4	16		16					37	\$ 2,623
4. Prepare Summary of Small Signs, Pavement Marking Summary & Traffic Signal Summary	3		1	2	4	16	4					27	\$ 2,047
5. Provide standard signing details as necessary	17		1	4	8	4	16					33	\$ 2,323
6. Coordinate with CoSA		2	0	4	4						2	12	\$ 1,040
SUBTOTAL	30	2	5	20	52	44	60	0	0	0	2	12	\$ 13,535
VI. MISCELLANEOUS ROADWAY													
1. Update Title Sheet and Index & Grading Summary			0		2		2					4	\$ 266
2. Prepare Driveway, Earthwork, Removal Items, Traffic Control, and SW3P Summary Sheets	6		0	4	8	16	24					52	\$ 3,552
3. Prepare Schedule of Barricades	1		0	1	4	2	2					9	\$ 656
4. Prepare Removal Item Sheets	4		0	2	8	4	16					30	\$ 2,008
5. Develop miscellaneous roadway details	6		2	2	16	4	16					40	\$ 2,878
6. Refine traffic control plans, detours, and sequence of work narrative including quantities & summaries			4	8	24	16	18					70	\$ 5,304
7. Calculate quantities and prepare summary sheets			1	2	12	12	8					35	\$ 2,579
8. Update opinion of probable construction cost using TxDOT Estimator Software			0	2		8						10	\$ 780
9. Prepare construction time estimate (CPM schedule) with Microsoft Project			1	2	8	1						12	\$ 990
10. Prepare list of Standard Sheets for project			0	0	2	12	8					22	\$ 1,514
11. Address review comments			2	4	8		24					38	\$ 2,622
SUBTOTAL	17	0	10	27	92	75	118	0	0	0	0	322	\$ 23,149
SUBTOTAL INTERMEDIATE DESIGN PHASE	51	5	28	135	312	131	358	0	0	0	16	986	\$ 74,270

City of San Antonio

Discretionary Contracts Disclosure*

For use of this form, see City of San Antonio Ethics Code, Part D, Sections 1&2
Attach additional sheets if space provided is not sufficient.
State Not Applicable for questions that do not apply.

**This form is required to be supplemented in the event there is any change in the information under (1), (2), or (3) below, before the discretionary contract is the subject of council action and no later than five (5) business days after any change about which information is required to be filed.*

Disclosure of Parties, Owners and Closely Related Persons

For the purpose of assisting the city in the enforcement of provisions contained in the City Charter and the code of ethics, an individual or business entity seeking a discretionary contract from the city is required to disclose in connection with a proposal for a discretionary contract:

(1) the identity of any **individual** who would be a party to the discretionary contract:

Don Durden, P.E., R.P.L.S., 85.834% Ownership, President
Ken Thomas, P.E., R.P.L.S., 3.75% Ownership, Principal - Municipal Division Manager
Chester Varner, R.P.L.S., 2.75% Ownership, Principal - Senior Project Surveyor
Alan Lindskog, P.E., R.P.L.S., 2.50% Ownership, Principal- Development Division Manager
Ken Koch, P.E., 1.9% Ownership, Principal-V.P./Director of Business Development
Joe Nix, P.E., R.P.L.S., P.T.O.E., 1.25% Ownership, Principal - Senior Project Engineer
Garland Galm, P.E., 1.22% Ownership, Principal-Transportation Division Manager
Mike Haberer, R.P.L.S., 0.55% Ownership, Principal-Survey Division Manager
Matt Van Wicklen, P.E., 0.25% Ownership, Principal - Vice President Employee Benefits

(2) the identity of any **business entity** that would be a party to the discretionary contract:
and the name of:

(A) any individual or business entity that would be a *subcontractor* on the discretionary contract;

N/A

(B) any individual or business entity that is known to be a *partner*, or a *parent* or *subsidiary business* entity, of any individual or business entity who would be a party to the discretionary contract;

N/A

(3) the identity of any *lobbyist* or *public relations firm* employed for purposes relating to the discretionary contract being sought by any individual or business entity who would be a party to the discretionary contract.

N/A

Political Contributions

Any individual or business entity seeking a discretionary contract from the city must disclose in connection with a proposal for a discretionary contract all political contributions totaling one hundred dollars (\$100) or more within the past twenty-four (24) months made directly or indirectly to any member of City Council, or to any political action committee that contributes to City Council elections, by any individual or business entity whose identity must be by an disclosed under (1), (2) or (3) above. Indirect contributions entity include, but are not limited to, contributions made through the officers, owners, or registered lobbyists of the entity.

Whom Made To:	Amount:	Date of Contribution:
Toni Moorhouse	\$200	5/25/01
Toni Moorhouse	\$500	1/28/02
Bobby Perez	\$100	8/6/02
Bonnie Conner	\$100	8/6/02
Carroll Schubert	\$100	8/6/02
Toni Moorhouse	\$100	8/14/02
Ed Garza	\$300	8/14/02

MAESTAS & BAILEY REVISED FEE

[illegible]

**CIVIL ENGINEERING CONSULTANTS
CLARK AVENUE, FAIR TO SOUTHCROSS**

Engineering Fee Proposal

TASK AND DESCRIPTION	SHEETS	PRINCP	PROJ	PROJ	EIT	ENGR	CADD	SURVEY	RPLS	SIT	CLERICAL	HOURS	COST
			MGR	ENGR		TECH	OPER.	CREW(S)					
HOURLY RATE		\$150.00	\$135.00	\$90.00	\$75.00	\$75.00	\$58.00	\$120.00	\$110.00	\$70.00	\$40.00		
FINAL DESIGN PHASE													
I. BASIC SERVICES													
1. Site visits			4	4	4							12	\$ 1,200
2. Quality Control		8										8	\$ 1,200
3. Establish horizontal & vertical surveying control			2		4			8	8	8		30	\$ 2,970
SUBTOTAL	0	8	6	4	8	0	0	8	0	8	0	50	\$ 5,370
II. ROADWAY DESIGN													
1. Refine Horizontal & Vertical Alignments			1	2	2		2					7	\$ 581
2. Refine & Submit Typical Sections				2			2					4	\$ 296
3. Refine roadway plan/profile sheets												0	
Clark			0	4	8		12					24	\$ 1,656
Intersecting Streets			0	4	8		12					24	\$ 1,656
4. Develop Retaining Wall Layout sheets including												0	
Clark(east side)			1	4	8		8					21	\$ 1,559
Clark(west side)			1	4	8		8					21	\$ 1,559
Intersecting Streets			1	4	8		8					21	\$ 1,559
5. Finalize roadway design cross sections, including			1	2	8		12					23	\$ 1,611
intersecting streets (300 sections)												0	
6. Prepare Intersection Grading Plans & address			0	2	8	8	2					20	\$ 1,496
pedestrian issues												0	
7. Assemble and plot plans			0	1	4	1	4				4	14	\$ 857
8. Coordinate with Subconsultants			4	4	4						2	14	\$ 1,280
9. Coordinate with CoSA			2	6	4						2	20	\$ 2,030
SUBTOTAL	0	2	15	39	70	9	70	0	0	0	8	213	\$ 16,140
III. UTILITY MAPPING & COORDINATION													
1. Obtain existing utility records and maps													\$ -
2. Request utility companies to uncover inaccessible													\$ -
surface features													\$ -
3. Request underground utility locates from utility companies													\$ -
4. Compile existing utility data collected in field into				1	1		2					4	\$ 281
electronic mapping files												0	
5. Determine location of existing utilities					1		1					2	\$ 133
6. Conduct field visits to verify utility locations				2	2							4	\$ 330
7. Request additional information from utility companies and				1	1							2	\$ 165
resolve discrepancies													\$ -
8. Submit utility layouts to utility companies for review													\$ -
and verification													\$ -
9. Edit utility layouts per utility company comments				1	1		2					4	\$ 281
10. Coordinate with utility companies on relocations				2	2							4	\$ 330
SUBTOTAL	0	0	0	7	8	0	5	0	0	0	0	20	\$ 1,520
IV. DRAINAGE													
1. Assemble Final Drainage Plans			0	1	2							3	\$ 240
2. Coordinate with Drainage Subconsultant			2	2	8						2	14	\$ 1,130
3. Review of Subconsultant plans			1	4		4						9	\$ 795
4. Coordinate with CoSA		1	2	4								7	\$ 780
5. Prepare final Storm Water Pollution Prevention Plans													\$ -
(SW3P) including SW3P controls and narrative.													\$ -
SUBTOTAL	0	1	5	11	10	4	0	0	0	0	2	33	\$ 2,945
V. SIGNING, PAVEMENT MARKINGS AND SIGNALIZATION													
1. Finalize Signing and Delineation Layouts including pay			1	2	4	4	4					15	\$ 1,147
item quantities.												0	
2. Finalize Pavement Marking Layouts including pay item			1	2	4	4	4					15	\$ 1,147
quantities.												0	
3. Prepare Traffic Signal layouts and quantities			1	2	4	4	2					13	\$ 1,031
4. Prepare phase sequence diagrams				4	4		4					12	\$ 892
5. Prepare construction details sheets				2	8		8					18	\$ 1,244
6. Update Summary of Small, Pavement Marking Summary			1	2	4	8	2					17	\$ 1,331
& Traffic Signal Summary												0	
7. Provide standard signing details as necessary.			1	2	4	8	4					19	\$ 1,447
9. Coordinate with CoSA			1	2	4						2	9	\$ 860
SUBTOTAL	0	1	7	20	32	28	28	0	0	0	2	118	\$ 9,099

**CIVIL ENGINEERING CONSULTANTS
CLARK AVENUE, FAIR TO SOUTHCROSS**

Engineering Fee Proposal

TASK AND DESCRIPTION	SHEETS	PRINCP	PROJ MGR	PROJ ENGR	EIT	ENGR TECH	CADD OPER.	SURVEY CREW(3)	RPLS	SIT	CLERICAL	HOURS	COST
HOURLY RATE		\$150.00	\$135.00	\$90.00	\$75.00	\$75.00	\$58.00	\$120.00	\$110.00	\$70.00	\$40.00		
FINAL DESIGN PHASE(Continued)													
VI. MISCELLANEOUS ROADWAY													
1. Finalize Title Sheet and Index			0	1			1					2	\$ 148
2. Finalize Grading, Driveway, Earthwork, Removal Items, Traffic Control, and SW3P Summary Sheets			1	2	4	8	2					17	\$ 1,331
3. Finalize Schedule of Barricades			0	1	2		2					5	\$ 356
4. Finalize Removal Item Sheets			1		2	2	2					7	\$ 551
5. Finalize miscellaneous roadway details			1	2	2	2	4					11	\$ 847
6. Finalize traffic control plans, detours, and sequence of work narrative including quantities & summaries.			1	4	4	4	12					25	\$ 1,791
7. Assemble and plot Standard Sheets	46		0	2	2	8	8					20	\$ 1,394
8. Calculate quantities and prepare summary sheets.			1	2	4	12	2					21	\$ 1,631
9. Update opinion of probable construction cost using TxDOT Estimator Software.			1	2		8						11	\$ 915
10. Prepare construction time estimate (CPM schedule) with Microsoft Project			2	8	8	0						18	\$ 1,590
11. Assemble and plot plans			0	2	4	8	8					22	\$ 1,544
12. Prepare special specifications for non-standard items, if required.			1	2	8	8						19	\$ 1,515
13. Prepare general notes, and special provisions	2		1	8		16						25	\$ 2,055
14. Attend Final Design Review Meeting			4	4								8	\$ 900
15. Address review comments			4	8	4	4	24					44	\$ 3,252
SUBTOTAL	48	0	18	48	44	80	65	0	0	0	0	255	\$ 19,820
VII. PUBLIC INVOLVEMENT													
1. Prepare for and attend two Public Meetings			4	4								8	\$ 900
SUBTOTAL	0	0	4	4	0	0	0	0	0	0	0	8	\$ 900
SUBTOTAL FINAL DESIGN PHASE	48	12	55	126	164	121	163	8	8	8	12	677	\$ 55,794

**CIVIL ENGINEERING CONSULTANTS
CLARK AVENUE, FAIR TO SOUTHCROSS**

Engineering Fee Proposal

TASK AND DESCRIPTION	SHEETS	PRINCP	PROJ MGR	PROJ ENGR	EIT	ENGR TECH	CADD OPER.	SURVEY CREW(3)	RPLS	SIT	CLERICAL	HOURS	COST
HOURLY RATE		\$150.00	\$135.00	\$90.00	\$75.00	\$75.00	\$58.00	\$120.00	\$110.00	\$70.00	\$40.00		
TxDOT P S & E PHASE													
1. Submit PS&E Package to COSA including: Four sets and two sealed & signed sets of plans (paper) Final Estimate of Probable Construction Cost General Notes and Specification Data Special Specifications and/or Special Provisions with Form 1815 Final Contract Time Determination Special Provision for Detour, Barricades, Warning Signs, and Sequence of Work PS&E Submission Data (Form1002) Public Affairs Office (PAO) Form			1	1	8		4				4	18	\$ 1,217
			1		4		4					9	\$ 735
			1	1			4					6	\$ 525
			1		2		4					7	\$ 595
												0	
			1	4			4					9	\$ 795
							2					2	\$ 150
												0	
			1	2			2					5	\$ 465
			2									2	\$ 270
2. Address TxDOT Area Office comments			2	2	4		16					24	\$ 1,678
3. Submit one paper copy to San Antonio District Office			1		2		4				2	9	\$ 597
4. Address TxDOT SA District Office review comments			1		2		8					11	\$ 749
5. Submit sealed/sealed original Mylar copies to TxDOT Austin office			1		2							3	\$ 265
												0	
6. Address TxDOT Austin Office review comments			1		4		8					13	\$ 899
7. Submit revisions to signed/sealed original Mylar plans to TxDOT Austin office			1		2		2					5	\$ 401
												0	
8. Prepare CD for transfer of files			1				2					3	\$ 251
SUBTOTAL	0	0	16	10	30	20	44	0	0	0	6	126	\$ 9,602
TOTALS	169	19	137	375	748	310	879	8	8	8	41	2533	\$ 197,580

DIRECT COSTS

PRELIMINARY DESIGN PHASE	\$ 57,914
INTERMEDIATE DESIGN PHASE	\$ 74,270
FINAL DESIGN PHASE	\$ 55,794
TxDOT PS&E PHASE	\$ 9,602
DIRECT COSTS	\$ 2,534
TOTAL PROJECT FEE	\$ 200,114

ITEM
Plotting/printing
Cross Sections
Mylars

SHEETS	COST	TOTALS
7000	\$ 0.25	\$ 1,750.00
14 rolls @	\$ 25.00	\$ 350.00
250	\$ 2.00	\$ 434.00
TOTAL DIRECT COST		\$ 2,534.00

CEC ENGINEERING FEE= \$ 200,114.00

CEC FEE= 200,114.00
RABA-KISTNER FEE= 13,129.42
MAESTAS & BAILEY FEE= 56,768.22

TOTAL FEE= 270,011.64

City of San Antonio
Discretionary Contracts Disclosure

For use of this form see City of San Antonio Ethics Code. Part D, Section 1&2

Whom Made To:	Amount:	Date of Contribution:
David Carpenter	\$100	10/21/02
Enrique Barrera	\$100	10/21/02
Carroll Schubert	\$150	5/1/03
Julian Castro	\$100	5/1/03
Enrique Barrera	\$150	5/1/03
Toni Moorhouse	\$150	5/1/03
John Clamp	\$150	5/1/03
Ed Garza	\$150	5/1/03
Roger Flores	\$150	5/21/03
Joel Williams	\$150	5/21/03
Richard Perez	\$150	5/21/03
Patty Radle	\$150	5/21/03
Art Hall	\$150	5/21/03
Chip Haas	\$150	5/21/03
Richard Perez	\$150	9/26/03

Disclosures in Proposals

Any individual or business entity seeking a discretionary contract with the city shall disclose any known facts which reasonably understood, raise a question¹ as to whether any city official would violate Section 1 of Part B by participating in official action relating to the discretionary contract.

Signature: 	Title: Principal Company: Civil Engineering Consultants	Date: 12/1/03

¹ For purpose of this rule, facts are "reasonably understood to raise a question" about the appropriateness of official action if a disinterested person would conclude that facts, if true, require recusal or require careful consideration of whether or not recusal is required.