

CONSENT AGENDA
ITEM NO. **13**

**CITY OF SAN ANTONIO
INTERDEPARTMENTAL MEMORANDUM
PUBLIC WORKS DEPARTMENT**

TO: Mayor and City Council

FROM: Thomas G. Wendorf, P.E., Public Works Director

THROUGH: Terry M. Brechtel, City Manager

COPIES: Melissa Byrne Vossmer; Andrew Martin; Peter Zanon; Milo D. Nitschke; File

SUBJECT: 2003 Sidewalks: Blanco – Lockhill-Selma to Patricia, Clark – Southcross to Hot Wells and Hot Wells – IH 37 to New Braunfels

DATE: March 4, 2004

SUMMARY AND RECOMMENDATIONS

This ordinance authorizes funds in the amount of \$259,934.49, payable to the Texas Department of Transportation (TxDOT), for construction costs and \$38,990.17 for construction contingency in connection with the 2003 Sidewalks: Blanco – Lockhill-Selma to Patricia, Clark – Southcross to Hot Wells and Hot Wells – IH 37 to New Braunfels, authorized Metropolitan Planning Organization (MPO) projects funded from General Obligations of the City, and located in Council Districts 3 and 9.

Staff recommends approval of this ordinance.

BACKGROUND INFORMATION

These three projects have been combined into one bid-package and will provide for the construction of six-foot sidewalks on both sides of the roadways on Blanco from Lockhill-Selma to Patricia, on Clark from Southcross to Hot Wells and on Hot Wells from IH 37 to New Braunfels.

This ordinance will provide for payment of funds to TxDOT for the City's portion of the project construction costs as shown in the letter received from TxDOT on January 22, 2004 and included herein as Attachment 2. As part of the implementation of Metropolitan Planning Organization (MPO) projects, it is the City's responsibility to fund 20% of project construction costs. TxDOT anticipates the receipt of construction bids in March, at which time the project will be let for construction. Project construction will be managed by TxDOT under an Advance Funding Agreement with the City of San Antonio.

POLICY ANALYSIS

Approval of this ordinance will be a continuation of City Council policy to participate in the development and construction of City selected and approved MPO projects, which are approved annually by Council.

FISCAL IMPACT

This is a one-time capital improvement expenditure within budget and included in the FY 04-09 Capital Improvement Program Budget. Funds in the amount of \$230,000.00 are available from 1999 General Obligation Street Bonds and \$68,924.66 are available from 2002 Certificates of Obligation, for a total amount of \$298,924.66 authorized payable as follows:

\$ 259,934.49	Payable to TxDOT for construction expenses
\$ 38,990.17	Construction contingency

COORDINATION

This request for ordinance has been coordinated with the Office of Management and Budget, the Finance Department and the Texas Department of Transportation.

SUPPLEMENTARY COMMENTS

The Discretionary Contracts Disclosure Form is not required.

ATTACHMENTS

1. Project Map
2. Letter, Texas Department of Transportation received January 22, 2004, with attachments

for 
Thomas G. Wendorf, P.E.
Director of Public Works

Melissa Byrne Vossmer
Assistant City Manager

Approved:

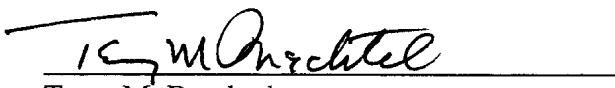
Terry M. Brechtel
City Manager

BLANCO - LOCKHILL SELMA TO PATRICIA

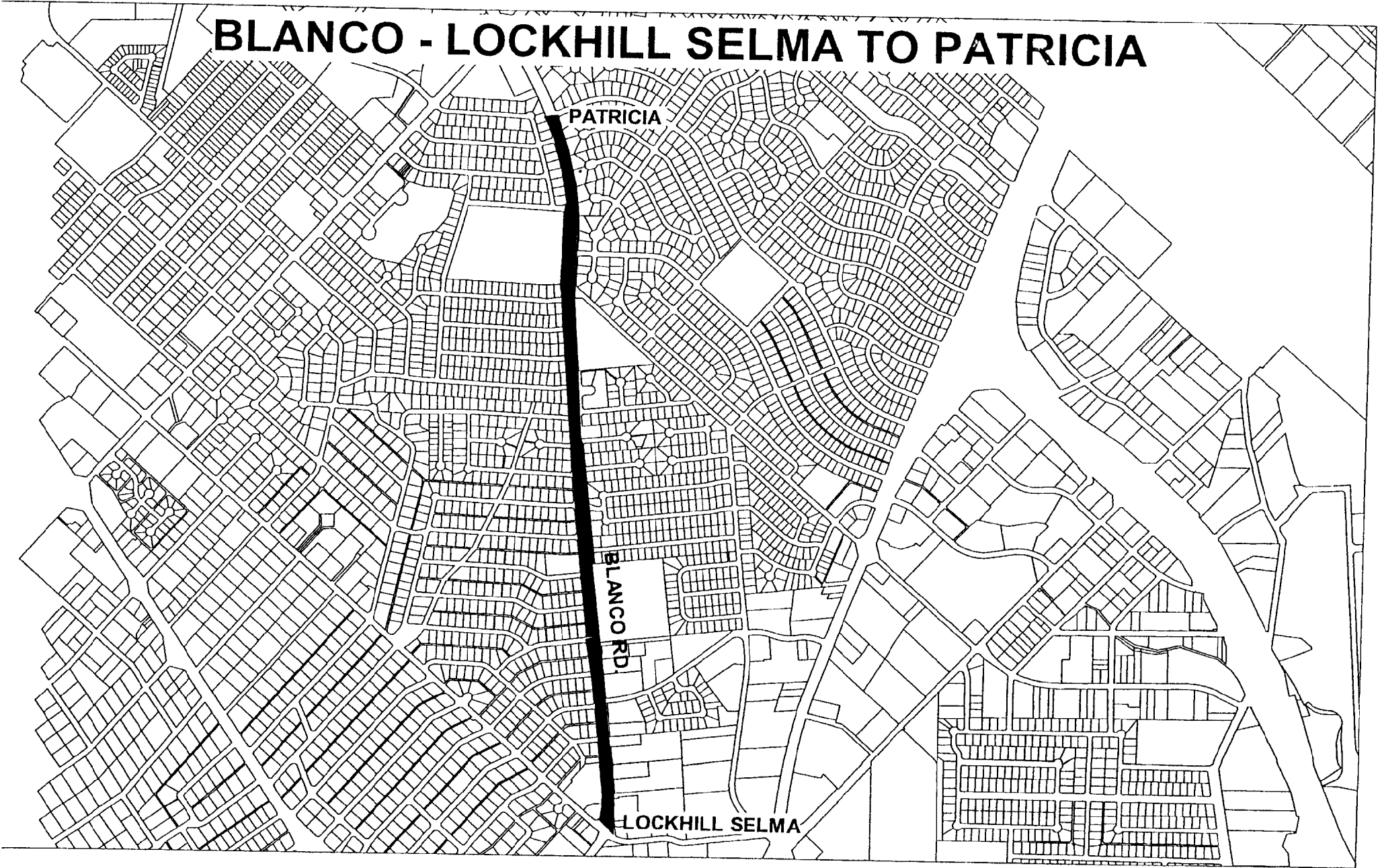

CLARK - SOUTHCROSS TO HOT WELLS

SOUTHCROSS

CLARK

HOT WELLS

N

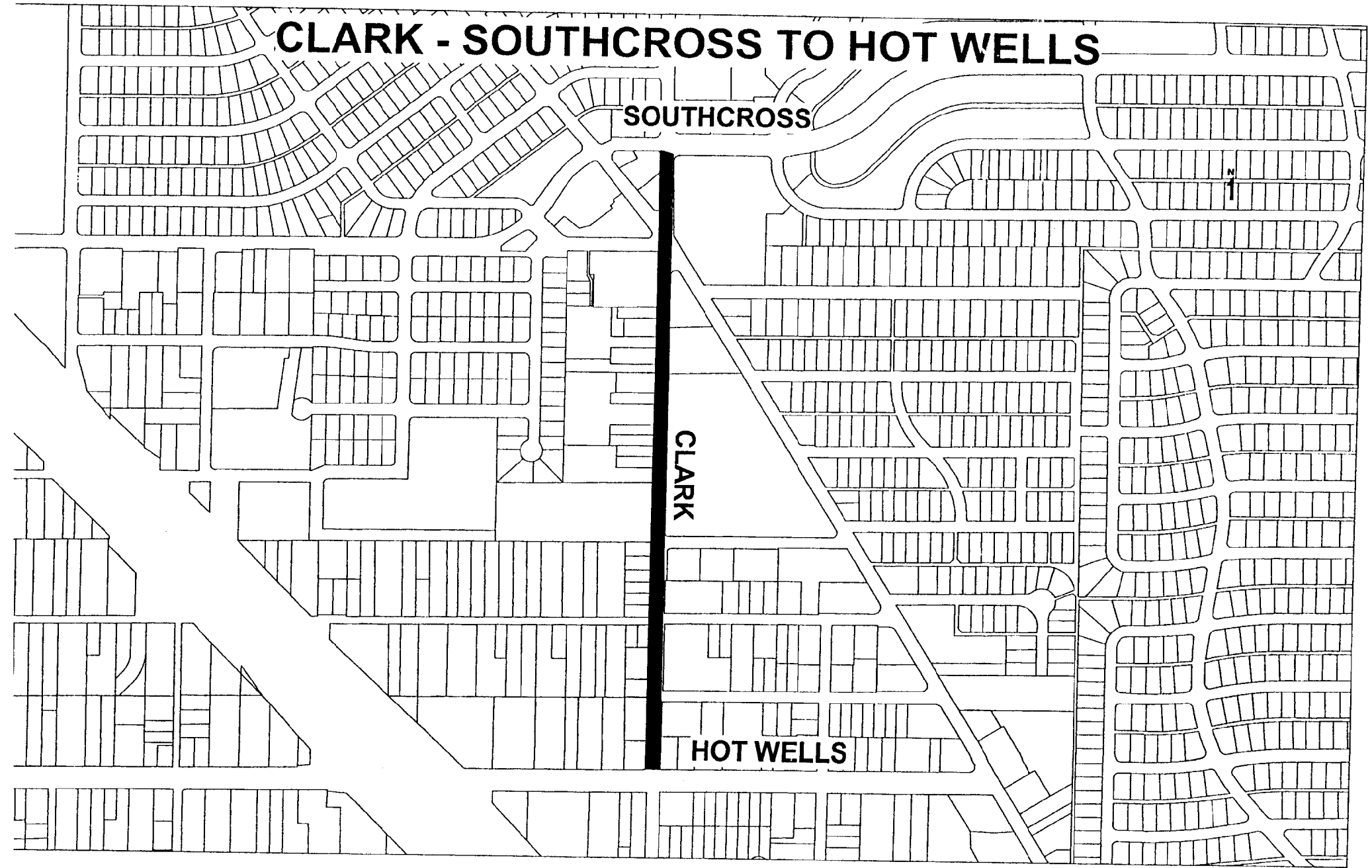

BETTY JEAN

HOT WELLS - I.H. 37 TO NEW BRAUNFELS

JUDITH

LENNON CT

AVONDALE

1

S NEW BRAUNFELS AVE

HOT WELLS

I.H. 37

STATE ST

SCIVERS

HILLIE

ARDENWOOD

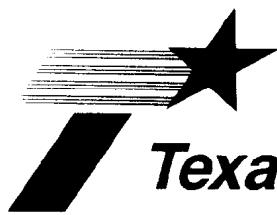

Texas Department of Transportation

P.O. BOX 29928 • SAN ANTONIO, TEXAS 78229-0928 • (210) 615-1110

January 20, 2004

The City of San Antonio
Attn: Mr. William Krause
Capital Programs Manager
P.O. Box 839966
San Antonio, Texas 78284-5126

RECEIVED

JAN 22 2004

CITY OF SAN ANTONIO
PUBLIC WORKS, CAPITAL PROGRAMS

Re: Control: 0915-12-353
Project: STP 99(790)MM
County: Bexar
Highway: Clark, Hotwells, Blanco

Dear Mr. Krause:

As you are probably aware, bids for the referenced project are scheduled for receipt in March. As detailed in our agreement, Article 5 Funding Responsibilities, Sections C & D, The City of San Antonio is obligated to remit the balance of its financial contribution for the construction of this Project within 30 days from receipt of written notification from the State. Therefore, a check made payable to the Texas Department of Transportation in the amount of \$259,934.49 must be forwarded as soon as possible. Otherwise, this project risks being pulled from the letting.

Naturally, your prompt attention to this matter would be greatly appreciated by all the parties involved. If you have any questions, or require additional information, please contact Melissa Jordan at 615-5817. Thank you, in advance, for your assistance.

Sincerely,

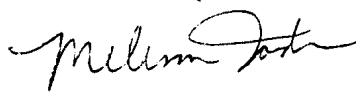
John A. Saldaña, PE
CCMO Manager

/jqe
Attach. A/S
cc: Bexar Metro Area Office

MIS.DCS.9601

DATE 01/13/04 TIME 09:51:56 PAGE 1

CONTRACT NO. 000000000
PROJECT STP 99(790)MM
CONTROL 0915-12-353
HIGHWAY CS
COUNTY BEXAR
DISTRICT 15

PROJECT AGREEMENT ESTIMATE
TEXAS DEPARTMENT OF TRANSPORTATION

ITEM NO.	DESC CODE	S.P. NO. ALT	DESCRIPTION	UNIT	ESTIMATED QUANTITY	PRICE PER UNIT	AMOUNT
PWP:		EDCP:	TAPERED MATCH:				

DISTRICT 15 COUNTY BEXAR CONTROL 0915-12-353 LENGTH .533 STP 99(790)MM

TYPE: CONSTRUCT SIDEWALKS
LIMITS FROM: IN SAN ANTONIO ON CLARK CONTROL 0915-12-353 WILL BE COMBINED INTO
TO : HOT WELLS TO SOUTHCROSS CONTROL 2708-01-027 AND CHARGED 24.3% OF GROUP A0

PREPARED BY JOHN KELLY, P.E. DIST ENGR APRIL 2003

ROADWAY ITEMS NET LENGTH .533 MILES

0100 0502			PREP ROW	STA	28.400	\$	1,845.000	\$	52,398.00
0162 0508	001		BLOCK SOD (BERMUDA)	SY	1,931.600		3.000		5,794.80
0168 0501			VEGETATIVE WATERING	MG	115.900		6.000		695.40
0420 0740	015		CL A CONC (ELEVATED SIDEWALK)	CY	32.000		600.000		19,200.00
0432 0501			RIPRAP (CONC) (CL B)	CY	14.000		250.000		3,500.00
0450 0683			RAIL (TY PR1)	LF	105.000		75.000		7,875.00
0500 0501			MOBILIZATION	LS	0.269		90,222.000		24,269.72
0502 0501	027		BARRICADES, SIGNS AND TRAF HANDLE	MO	11.000		3,500.000		38,500.00
0529 0501			CONC CURB (TY 1)	LF	1,748.000		8.810		15,399.88
0530 0717	012		DRIVEWAY (CONC) (6") (TY 3) (COMMERCIAL)	SY	783.600		36.000		28,209.60
0530 0718	012		DRIVEWAY (CONC) (5") (TY 2) (RESIDENTIAL)	SY	498.800		36.000		17,956.80
0531 0507	018		CONCRETE SIDEWALK (4 ")	SY	2,766.100		36.000		99,579.60
0649 0504			RELOC SMALL RDS SGN ASSMS	EA	5.000		520.000		2,600.00
1058 0504			COMPOST MANF TOPSOIL (PB) (4")	SY	1,659.600		2.700		4,480.92
5145 0501			SANDBAGS FOR EROSION CONTROL	EA	108.000		11.000		1,188.00
5249 0501			TEMP SEDMT CONT FENCE	LF	1,200.000		1.150		1,380.00
5249 0503			TEMP SEDMT CONT FENCE (REMOV)	LF	1,200.000		1.400		1,680.00
5866 0501			CURB RAMP AND LANDING (TY 1)	EA	6.000		320.000		1,920.00
5866 0502			CURB RAMP AND LANDING (TY 2)	EA	2.000		320.000		640.00

SUBTOTAL \$ 327,267.72
ENGINEERING AND CONTINGENCIES 47,453.82

TOTAL ROADWAY ITEMS \$ 374,721.54

CONTRACTOR FORCE ACCOUNT WORK (PART)

ITEM NO.	DESC CODE	S.P. NO. ALT	DESCRIPTION	UNIT	ESTIMATED QUANTITY	PRICE PER UNIT	AMOUNT
			01 CELLULAR PHONE	LS	1.000	\$	1,100.00
TOTAL							\$ 1,100.00

CONTRACTOR FORCE ACCOUNT WORK

			01 COMPOST TESTING	LS	1.000	\$	350.00
TOTAL							\$ 350.00

ITEM NO.	DESC CODE	S.P. NO. ALT	DESCRIPTION	UNIT	ESTIMATED QUANTITY	PRICE PER UNIT	AMOUNT
----------	-----------	--------------	-------------	------	--------------------	----------------	--------

PWP: EDCP: TAPERED MATCH:

DISTRICT 15 COUNTY BEXAR CONTROL 0915-12-359 LENGTH .453 STP 99(790)MM

TYPE: CONSTRUCT SIDEWALKS

LIMITS FROM: IN SAN ANTONIO ON HOT WELLS FROM
TO : NE BRAUNFELS TO IH 37CONTROL 0915-12-359 WILL BE COMBINED INTO
CONTROL 2708-01-027 AND CHARGED 25.3% OF GROUP A0

PREPARED BY JOHN KELLY, P.E. DIST ENGR APRIL 2003

ROADWAY ITEMS NET LENGTH .453 MILES

0100	0502		PREP ROW	STA	24.500	\$	1,845.000	\$	45,202.50
0162	0508	001	BLOCK SOD (BERMUDA)	SY	2,288.000		3.000		6,864.00
0168	0501		VEGETATIVE WATERING	MG	137.300		6.000		823.80
0500	0501		MOBILIZATION	LS	0.245		90,222.000		22,104.39
0529	0501		CONC CURB (TY 1)	LF	4,008.000		8.810		35,310.48
0530	0718	012	DRIVEWAY (CONC) (5") (TY 2) (RESIDENTIAL)	SY	2,144.900		36.000		77,216.40
0531	0507	018	CONCRETE SIDEWALK (4 ")	SY	2,532.700		36.000		91,177.20
0649	0504		RELOC SMALL RDS SGN ASSMS	EA	7.000		520.000		3,640.00
1058	0504		COMPOST MANF TOPSOIL (PB) (4")	SY	2,288.000		2.700		6,177.60
5145	0501		SANDBAGS FOR EROSION CONTROL	EA	80.000		11.000		880.00
5249	0501		TEMP SEDMT CONT FENCE	LF	2,031.500		1.150		2,336.23
5249	0503		TEMP SEDMT CONT FENCE (REMOV)	LF	2,031.500		1.400		2,844.10
5866	0501		CURB RAMP AND LANDING (TY 1)	EA	11.000		320.000		3,520.00

SUBTOTAL	\$	298,096.70
ENGINEERING AND CONTINGENCIES		43,224.02

TOTAL ROADWAY ITEMS	\$	341,320.72
---------------------	----	------------

ITEM NO.	DESC CODE	S.P. NO. ALT	DESCRIPTION	UNIT	ESTIMATED QUANTITY	PRICE PER UNIT	AMOUNT
----------	-----------	--------------	-------------	------	--------------------	----------------	--------

PWP: EDCP: TAPERED MATCH:

DISTRICT 15 COUNTY BEXAR CONTROL 2708-01-027 LENGTH 1.638 STP 99(790)MM

TYPE: CONSTRUCT SIDEWALKS

LIMITS FROM: ON BLANCO RD FROM LOCKHILL SELMA
TO : WEST AVENUE

CONTROL 2708-01-027 WILL BE COMBINED INTO
CONTROL 2708-01-027 AND CHARGED 50.4% OF GROUP A0

ITEM NO.	DESC CODE	S.P. NO. ALT	DESCRIPTION	UNIT	ESTIMATED QUANTITY	PRICE PER UNIT	AMOUNT
----------	-----------	--------------	-------------	------	--------------------	----------------	--------

PREPARED BY JOHN KELLY, P.E. DIST ENGR APRIL 2003

ROADWAY ITEMS NET LENGTH 1.638 MILES

0100	0502		PREP ROW	STA	94.500	\$ 1,845.000	\$ 174,352.50
0162	0508	001	BLOCK SOD (BERMUDA)	SY	4,103.000	3.000	12,309.00
0168	0501		VEGETATIVE WATERING	MG	246.200	6.000	1,477.20
0500	0501		MOBILIZATION	LS	0.486	90,222.000	43,847.89
0530	0717	012	DRIVEWAY (CONC) (6") (TY 3) (COMMERCIAL)	SY	1,281.200	36.000	46,123.20
0531	0507	018	CONCRETE SIDEWALK (4")	SY	7,183.100	36.000	258,591.60
0649	0504		RELOC SMALL RDS SGN ASSMS	EA	24.000	520.000	12,480.00
1058	0504		COMPOST MANF TOPSOIL (PB) (4")	SY	4,268.000	2.700	11,523.60
5145	0501		SANDBAGS FOR EROSION CONTROL	EA	480.000	11.000	5,280.00
5249	0501		TEMP SEDMT CONT FENCE	LF	4,725.000	1.150	5,433.75
5249	0503		TEMP SEDMT CONT FENCE (REMOV)	LF	4,725.000	1.400	6,615.00
5866	0501		CURB RAMP AND LANDING (TY 1)	EA	39.000	320.000	12,480.00
5866	0502		CURB RAMP AND LANDING (TY 2)	EA	4.000	320.000	1,280.00
5866	0509		CURB RAMP AND LANDING (TY 20)	EA	2.000	320.000	640.00

SUBTOTAL	\$ 592,433.74
ENGINEERING AND CONTINGENCIES	85,902.89

TOTAL ROADWAY ITEMS \$ 678,336.63

SUMMARY: CONTROL 0915-12-353 PROJECT STP 99(790)MM

	ESTIMATED COST	LENGTH
ROADWAY ITEMS	\$ 374,721.54	.533
CONTRACTOR FORCE ACCOUNT WORK (PART)	\$ 1,100.00	
CONTRACTOR FORCE ACCOUNT WORK	\$ 350.00	
CONTR BID ITEMS	\$ 327,267.72	
TOTAL CONTROL	\$ 376,171.54	.533

FUNDING TOTALS

APPN-CODE	APPL-PCT	TOTAL-PROJ-COST	FED-PERCENT	FEDERAL-FUNDS	STA-PERCENT	STATE-FUNDS	LOC-PERCENT	LOCAL-FUNDS
H23	100.0	\$ 376,171.54	80.0	\$ 300,937.23	0.0	\$ 0.00	20.0	\$ 75,234.30

CONTROL 0915-12-359 PROJECT STP 99(790)MM

ROADWAY ITEMS	\$ 341,320.72	.453
CONTR BID ITEMS	\$ 298,096.70	
TOTAL CONTROL	\$ 341,320.72	.453

FUNDING TOTALS

APPN-CODE	APPL-PCT	TOTAL-PROJ-COST	FED-PERCENT	FEDERAL-FUNDS	STA-PERCENT	STATE-FUNDS	LOC-PERCENT	LOCAL-FUNDS
H23	100.0	\$ 341,320.72	80.0	\$ 273,056.57	0.0	\$ 0.00	20.0	\$ 68,264.14

CONTROL 2708-01-027 PROJECT STP 99(790)MM		
ROADWAY ITEMS	\$ 678,336.63	1.638
CONTR BID ITEMS	\$ 592,433.74	
TOTAL CONTROL	\$ 678,336.63	1.638

FUNDING TOTALS

APPN-CODE	APPL-PCT	TOTAL-PROJ-COST	FED-PERCENT	FEDERAL-FUNDS	STA-PERCENT	STATE-FUNDS	LOC-PERCENT	LOCAL-FUNDS
H23	100.0	\$ 678,336.63	80.0	\$ 542,669.30	0.0	\$ 0.00	20.0	\$ 135,667.32
		TOTAL PROJECT		\$ 1,395,828.89				2.624
		TOTAL BID ITEMS		\$ 1,217,798.16				

CONTRACT SUMMARY

	ESTIMATED COST	LENGTH
0915-12-353 STP 99(790)MM		
ROADWAY ITEMS	\$ 374,721.54	.533
CONTRACTOR FORCE ACCOUNT WORK (PART)	\$ 1,100.00	
CONTRACTOR FORCE ACCOUNT WORK	\$ 350.00	
TOTAL 0915-12-353	\$ 376,171.54	.533
0915-12-359 STP 99(790)MM		
ROADWAY ITEMS	\$ 341,320.72	.453
TOTAL 0915-12-359	\$ 341,320.72	.453
2708-01-027 STP 99(790)MM		
ROADWAY ITEMS	\$ 678,336.63	1.638
TOTAL 2708-01-027	\$ 678,336.63	1.638
TOTAL BID ITEMS	\$ 1,217,798.16	
ENGINEERING AND CONTINGENCIES	176,580.73	
TOTAL MISCELLANEOUS COST	1,450.00	
TOTAL COST	\$ 1,395,828.89	2.624

75234.31
 $+ 13,064.20 PE$
 $88,298.51$
 $- 12,111.33 in escrow$
 $76,187.18$

 $135,667.33$
 $- 10,579.00$
 $125,088.33$

 $\$259,934.49$

TEXAS DEPARTMENT OF TRANSPORTATION

CONTRACT SUMMARY

CONTRACT NUMBER	PROJECT NUMBER	COUNTY		TOTAL BID		TOTAL BID + E&C
00000000	STP 99(790)MM, ETC.	015	\$	1,217,798.16	\$	1,394,378.89
TOTALS			\$	1,217,798.16	\$	1,394,378.89

CONTROL 0915-12-353 WILL BE COMBINED INTO CONTROL 2708-01-027 AND CHARGED 24.3% OF GROUP A0
CONTROL 0915-12-359 WILL BE COMBINED INTO CONTROL 2708-01-027 AND CHARGED 25.3% OF GROUP A0
CONTROL 2708-01-027 WILL BE COMBINED INTO CONTROL 2708-01-027 AND CHARGED 50.4% OF GROUP A0